

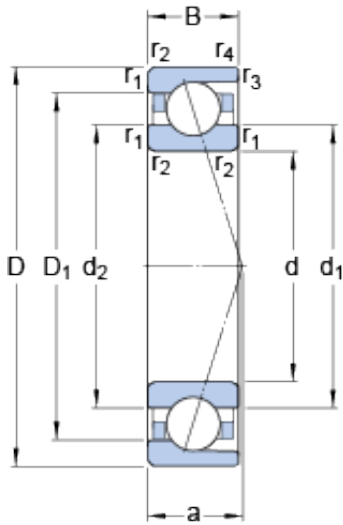

SKF BEARING LTD



70 mm x 100 mm x 16 mm SKF 71914 ACD/P4A angular contact ball bearings

Bearing No. 71914 ACD/P4A

71914 ACD/P4A Bearing 2D drawings and 3D CAD models

Size	100x70x16 mm
Bore Diameter	100 mm
Outer Diameter	70 mm
Width	16 mm
d	70 mm
D	100 mm
B	16 mm
d ₁	79.2 mm
d ₂	79.2 mm
D ₁	90.8 mm
r _{1,2} - min.	1 mm
r _{3,4} - min.	0.3 mm
a	27.9 mm
d _a - min.	74.6 mm
d _b - min.	74.6 mm
D _a - max.	95.4 mm
D _b - max.	98 mm
r _a - max.	1 mm
r _b - max.	0.3 mm
d _n	81.7 mm
Basic dynamic load rating - C	32.5 kN
Basic static load rating - C ₀	32.5 kN
Fatigue load limit - P _u	1.4 kN
Limiting speed for grease	11000 r/min



SKF BEARING LTD

Lubrication	
Limiting speed for oil lubrication	18000 mm/min
Ball - D_w	9.525 mm
Ball - z	24
G_{ref}	4.5 cm ³
Calculation factor - e	0.68
Calculation factor - Y_2	0.87
Calculation factor - Y_0	0.38
Calculation factor - X_2	0.41
Calculation factor - Y_1	0.92
Calculation factor - Y_2	1.41
Calculation factor - Y_0	0.76
Calculation factor - X_2	0.67
Preload class A - G_A	200 N
Preload class B - G_B	400 N
Preload class C - G_C	800 N
Preload class D - G_D	1600 N
Calculation factor - f	1.19
Calculation factor - f_1	0.98
Calculation factor - f_{2A}	1
Calculation factor - f_{2B}	1.04
Calculation factor - f_{2C}	1.08
Calculation factor - f_{2D}	1.14
Calculation factor - f_{HC}	1
Preload class A	180 N/micron
Preload class B	235 N/micron
Preload class C	314 N/micron
Preload class D	428 N/micron



SKF BEARING LTD

Category	Precision Ball Bearings
Inventory	0.0
Manufacturer Name	SKF
Minimum Buy Quantity	N/A
Weight / Kilogram	0.35
Product Group	B04270
Enclosure	Open
Precision Class	ABEC 7 ISO P4
Material - Ball	Steel
Number of Bearings	1 (Single)
Contact Angle	25 Degree
Preload	None
Raceway Style	1 Rib Outer Ring
Cage Material	Phenolic
Rolling Element	Ball Bearing
Flush Ground	No
Inch - Metric	Metric
Other Features	Single Row Angular Contact High Precision
Long Description	70MM Bore; 100MM Outside Diameter; 16MM Width; Open Enclosure; ABEC 7 ISO P4 Precision; Steel Ball Material; 1 (Single) Bearings; 25 Degree Contact Angle; Phenolic Cage Material; 1 Rib Outer Ring Ra
Category	Precision Ball Bearings
UNSPSC	31171531
Harmonized Tariff Code	8482.10.50.28
Noun	Bearing
Keyword String	Angular Contact Ball
Manufacturer URL	http://www.skf.com
Manufacturer Item Number	71914 ACD/P4A



SKF BEARING LTD

Weight / LBS	0.774
Outside Diameter	3.937 Inch 100 Millimeter
Bore	2.756 Inch 70 Millimeter
Width	0.63 Inch 16 Millimeter
d_1	79.2 mm
d_2	79.2 mm
D_1	90.8 mm
$r_{1,2}$ min.	1 mm
$r_{3,4}$ min.	0.3 mm
d_a min.	74.6 mm
d_b min.	74.6 mm
D_a max.	95.4 mm
D_b max.	98 mm
r_a max.	1 mm
r_b max.	0.3 mm
d_n	81.7 mm
Basic dynamic load rating C	32.5 kN
Basic static load rating C_0	32.5 kN
Fatigue load limit P_u	1.37 kN
Attainable speed for grease lubrication	11000 r/min
Attainable speed for oil-air lubrication	18000 r/min
Ball diameter D_w	9.525 mm
Number of balls z	24
Reference grease quantity G_{ref}	4.5 cm ³
Preload class A G_A	200 N
Static axial stiffness, preload class A	180 N/ μ m
Preload class B G_B	400 N
Static axial stiffness, preload class B	235 N/ μ m
Preload class C G_C	800 N



SKF BEARING LTD

Static axial stiffness, preload class C	314 N/ μ m
Preload class D G_D	1600 N
Static axial stiffness, preload class D	428 N/ μ m
Calculation factor f	1.19
Calculation factor f_1	0.98
Calculation factor f_{2A}	1
Calculation factor f_{2B}	1.04
Calculation factor f_{2C}	1.08
Calculation factor f_{2D}	1.14
Calculation factor f_{HC}	1
Calculation factor e	0.68
Calculation factor (single, tandem) Y_2	0.87
Calculation factor (single, tandem) Y_0	0.38
Calculation factor (single, tandem) X_2	0.41
Calculation factor (back-to-back, face-to-face) Y_1	0.92
Calculation factor (back-to-back, face-to-face) Y_2	1.41
Calculation factor (back-to-back, face-to-face) Y_0	0.76
Calculation factor (back-to-back, face-to-face) X_2	0.67
Mass bearing	0.33 kg